

PEDO

Wastewater Submersible Pump



Application Limits

- 10 m maximum immersion depth
- Maximum liquid temperature + 40°C
- Passage of suspended solids from 20 mm to 40 mm

Standard Supply

- Complete with 8 m long power cable
- Portable type
- Float switch available as option

Installation and Use

PEDO Cast Iron submersible pumps are suitable for draining dirty water and sewage in domestic and civil applications. They are ideal for pumping sewage water, waste water, surface water and water mixed with mud.

PEDO - Wastewater Submersible Pump

Technical Characteristics

- Cast iron body and impeller
- Stainless steel motor shaft
- Carbon-ceramic mechanical seal
- Float switch available as option
- Motor insulation class B
- Motor Protection: IP68
- PH: 6 to 10
- Density of liquid 1.3 g/cm³

Moveable Soft Installation

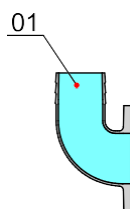

Hard Pipe Installation

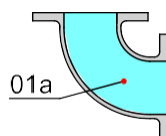

Auto-coupled Installation

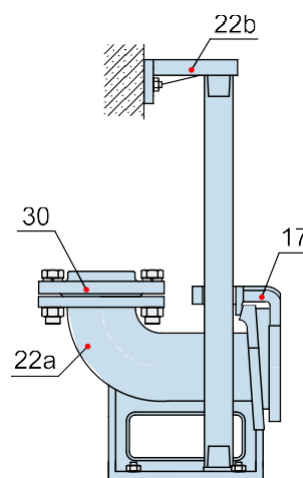

Materials of Construction

Item No.	Part name	Material
01	Hose coupling	Cast iron
01a	Hose coupling	Cast iron
03	Terminal box	Cast iron
05	Upper cover	Cast iron
06	Up-Bearing house	Cast iron
07	Bearing house	Cast iron
10	Seal bracket	Cast iron
11	Motor body	Cast iron
13	Pump body	Cast iron
14	Impeller	Cast iron
17	Coupling adapter	Cast iron
22	Seat assembly	Cast iron
22a	Coupling seat	Cast iron
22b	Upper guide support	Cast iron
27	Stator	Cast iron
28	Rotor	Shaft : AISI304SS
30	Flange	Cast iron
31a	Bearing	Ball bearing
31b	Bearing	Ball bearing
33	Motor protector	
34	Mechanical seal	Sic-Sic/Carbon-Ceramic
35	Oil seal	
47	Cable	

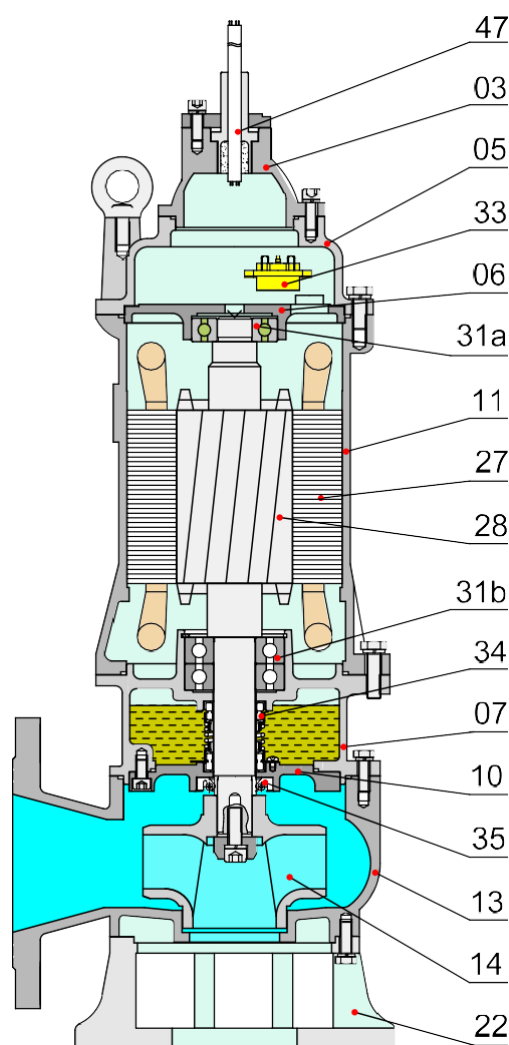

Model 50Hz	Voltage	Current	Motor power		Outlet		Rated capacity	Rated head	Max capacity	Max Head	Impeller Passage
	V	A	kW	HP	in	mm	m³/h	m	m³/h	m	mm
PEDO 50/2.2-1	400	5	2.2	3	2	50	15	19	40	22	20
PEDO 65/2.2-1	400	5	2.2	3	2½	65	25	16	42	22	20
PEDO 80/2.2-1	400	5	2.2	3	3	80	40	9	64	16	30
PEDO 50/3.0-1	400	6.5	3	4	2	50	15	25	46	28	20
PEDO 65/3.0-1	400	6.5	3	4	2½	65	25	22	52	26/29	20
PEDO 80/3.0-1	400	6.5	3	4	3	80	40	13	75	20	30
PEDO 100/3.0-1	400	6.5	3	4	4	100	60	9	92	19	30
PEDO 65/4.0-1	400	8.9	4	5.5	2½	65	25	28/27	58	33	20
PEDO 80/4.0-1	400	8.9	4	5.5	3	80	40	18	81	24	30
PEDO 100/4.0-1	400	8.9	4	5.5	4	100	60	13	93	24	30
PEDO 50/5.5-1	400	11.7	5.5	7.5	2	50	15	40/38	52	42	20
PEDO 80/5.5-1	400	11.7	5.5	7.5	3	80	30	30	47	36	25
PEDO 100/5.5-1	400	11.7	5.5	7.5	4	100	65	15	110	25	30

PEDO